

mistral[®]

COOKING WITH CONVENIENCE

Blender



Instruction Manual

Model: MB555

Important Safeguards

When using electrical appliances, in order to reduce the risk of fire, electric shock and/or injury to persons, basic safety precautions should always be followed, including:

For Your Safety

Read all instructions carefully, even if you feel you are quite familiar with the appliance.

- To protect against the risk of electric shock DO NOT IMMERSE the motor base, power plug and cord into water or any other liquid.
- This appliance is not intended for use by persons (including children) with reduced physical, sensory and mental capabilities, or lack of experience and knowledge, unless they have been given supervision or instruction concerning use of the appliance by a person responsible for their safety.
- Never leave an appliance unattended when in use.
- Children should be supervised to ensure that they do not play with the appliance.
- Do not touch any moving parts.
- Keep hands and utensils out of container while blending to reduce the risk of severe injury to persons or damage to the blender. A scraper may be used but must be used only when the blender is not running.
- To reduce the risk of injury, never place blade assembly on the motor base without the jar properly attached.
- Do not operate the appliance when empty.
- Switch off and remove the plug from the power outlet before cleaning or when not in use. To unplug, grasp the plug and pull from the power outlet. Never pull the power cord and never carry the appliance by the power cord.
- Do not operate any appliance with a damaged power cord or plug after the appliance malfunctions, or is dropped or damaged in any manner.
- Do not use outdoors.
- Store unit indoors in a dry location.

- Do not let the power cord hang over the edge of table or counter, or touch hot surfaces. Do not operate or place any part of this appliance on or near a hot gas or electric burner or in a heated oven.
- The use of attachments or accessories not recommended or sold by the manufacturer may cause fire, electric shock or injury.
- Operate on a level surface. Operating on sinks, drainboards or uneven surfaces must be avoided.
- Do not use any appliance for anything other than its intended use. This product is intended for household use only.
- Do not attempt to repair or disassemble the appliance.
- When removing the blender from the motor unit, wait until the blades have completely stopped.
- Always operate blender with cover in place.
- Handle the sharp blender blades carefully to avoid cuts and injuries.
- Never insert utensils into the appliance when the appliance is running.
- Do not touch the blades when removing food from the jar or when removing the blades for cleaning as they are sharp.
- Make sure that you do not overfill the jar. Do not exceed the maximum level indicated on the jug.
- Never connect this appliance to a timer switch or remote control system in order to avoid a hazardous situation.
- Do not leave the Blender unattended when operating.
- Be careful if hot liquid is poured into the blender as it can be ejected out of the appliance due to a sudden steaming.

Warning

If the supply power cord is damaged, the power cord must be replaced by the manufacturer, its service agent or similarly qualified persons in order to avoid a hazard.

This product has not been designed for any uses other than those specified in this booklet.

Save These Instructions

Features of Your Blender

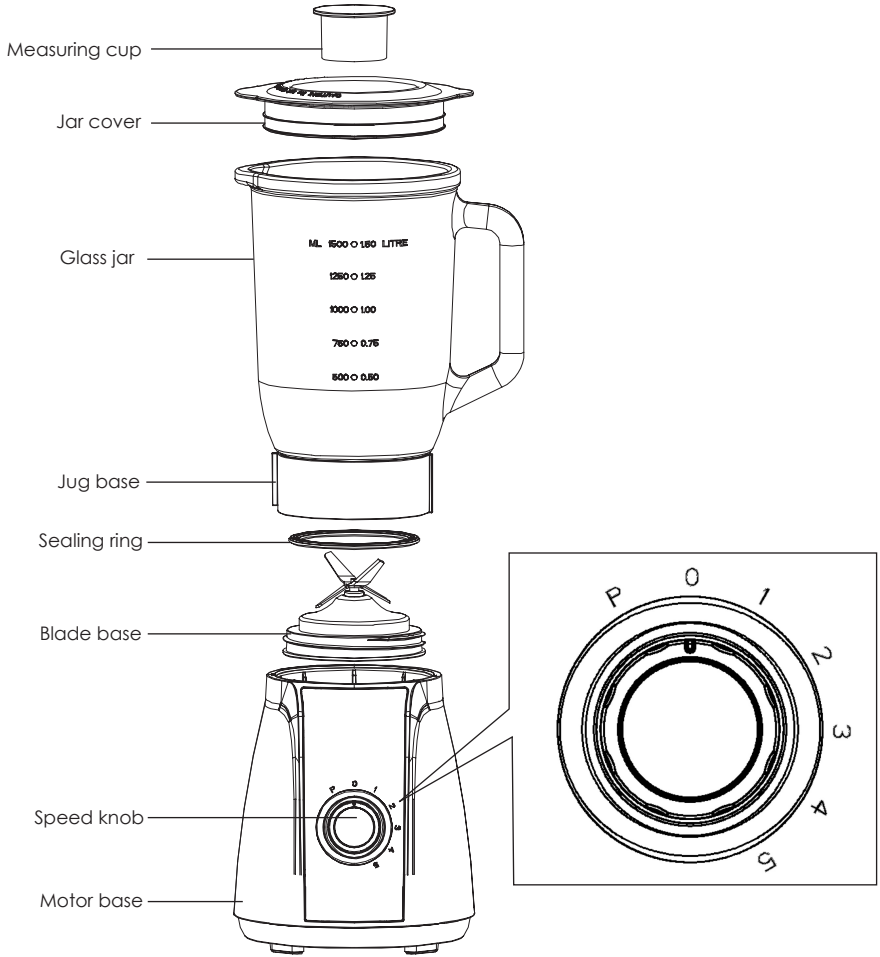

Getting to Know Your Blender

Congratulations on the purchase of your new Blender.

Before using your new Blender for the first time, it is extremely important that you read and follow the instructions in this Use and Care booklet, even if you feel that you are familiar this type of appliance.

In particular, please pay close attention to section entitled IMPORTANT SAFEGUARDS. Find a safe and convenient place to keep this booklet for future reference.

This appliance has been designed to operate from a standard domestic power outlet. It is not intended for industrial or commercial use.

Before Using the Blender for the First Time

Carefully unpack the unit and remove all packaging material. All parts of the blender are to be thoroughly cleaned before being used for the first time. Wipe the motor base with a damp cloth.

Take care not to submerge the motor base, power plug or cord in the water. Ensure it is thoroughly dry.

Pay careful attention to the sharp blades.

How to assemble the Blender

1. Place all parts on a horizontal surface.
 2. The jar assembly (including the measure cup, lid and its sealing ring) has already been assembled onto the motor unit. Disassemble to wash all detachable parts except the motor base referring to the Care and Cleaning.
 3. Once all parts have been cleaned and dry thoroughly, reassemble.
- (1) Invert the glass jar onto a level surface, holding the jar handle, put the sealing ring and blade assembly onto the jar base bottom and secure the blade assembly by turning it anti-clockwise until tight.(See Fig.1)

- (2) Reposition the jar assembly with its opening upwards. Wrap the sealing ring around the lid and put the lid onto the jar assembly. Place the measuring cup exactly into the lid. (See Fig.2)
- (3) Finally, place the assembled jar onto the motor base by aligning the strip on the jug base with the slots on the motor base. (See Fig.3)

Warning: Jar and jar base is fixed. Do not try to remove the jug base or twist the jar when the jug is placed on the motor base. Blades are very sharp. Handle with care.

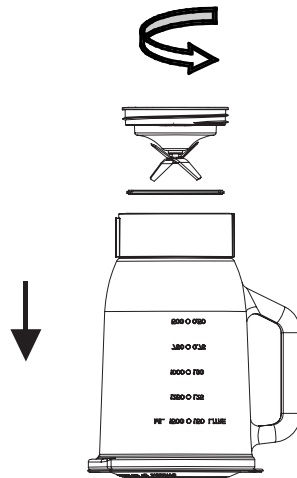

fig.1

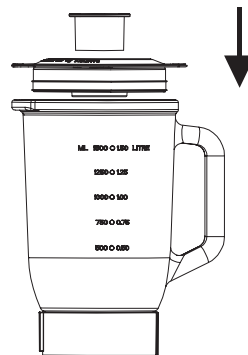

fig.2

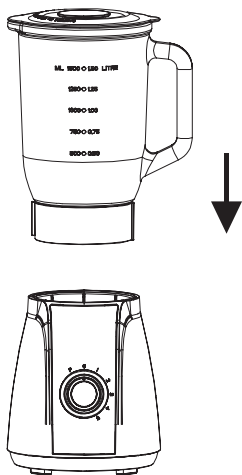

fig.3

How to use the Blender

1. Peel and core the fruit or vegetables and then cut it into small dices.
2. Place the food to be blended into the jar (See Fig.4). Usually, certain amount of purified water has to be added to facilitate the smooth running of appliance.

Warning: Do not overfill. The amount of mixture should not exceed the max. level 1500ml as indicated on the glass jar. Never use boiling liquids or run the appliance empty.

3. Put the lid on the jar. Be sure the measuring cup is at place.
4. Plug the power cord into a standard wall outlet.
5. Turn the speed knob to the appropriate speed setting.
6. For quick or delicate blending tasks, turn the speed knob to P position and hold for a few seconds and then release, the knob will reset to "0" position automatically. Operate several times until the consistence you want is obtained.
7. If you want to add ingredients while the blender is working, remove the measuring cup and place through the lid opening. (See Fig.5)

8. When crushing ice or hard food, keep one hand firmly on the lid.
9. When the consistence you desire is obtained, turn the knob to "0" position.

Note:

(1) For each use, the consecutive operation time should not exceed 2 minutes. at least 10 minutes rest time must be maintained between two continuous cycles, let the unit cool to room temperature before performing next operation cycle.

(2) If you want to stop the machine during operation, turn the knob to "0" position anytime.

Before blending, add food to be blended into the jar.

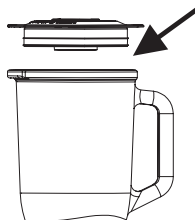

fig.4

During blending, add the ingredient through the lid opening.

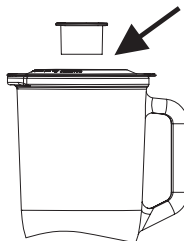

fig.5

Important operating tips

- For best circulation of food that are to be blended with some liquid, pour the liquid into the jar first, then add solids.
- Some of the tasks that cannot be performed efficiently with a blender are: beating egg whites, whipping cream, mashing potatoes, grinding meat, mixing dough, extracting juice from fruit and vegetable.
- The following items should never be placed in the unit as they may cause damage: bones, large pieces of solid, frozen food, or tough foods such as turnips.
- To crush ice, add up to 6 ice cubes. If more ice is needed, remove the cup and add cubes one by one through the lid opening.
- Do not run the appliance for more than 2 minutes per time, and only wait until the unit is cooled to room temperature before performing next operation cycles.

Care & Cleaning

Always remove the mains plug from the wall socket and wait it cool down before cleaning the appliance.

Dismantle all detachable parts. Remove the jar assembly from the motor base. To detach the blade assembly by turning it clockwise from the jar base, and remove the sealing ring and blade assembly (see fig.6). In addition, detach the jar cover sealing ring from the jar cover.

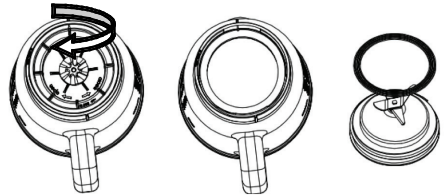

fig.6

Never immerse the motor base, plug or cord in water or any other liquids.

Clean the outside of the motor base with a damp cloth.

Clean the lid and measuring cup in hot soapy water then rinse them thoroughly.

To clean the glass jar. Pour a little warm soapy water into the jar and turn the knob to P position for a few seconds. And then empty the jar.

put the glass jar in the dishwasher. All non-electrical parts are dishwasher safe.

Ensure the glass jar is thoroughly dry before use.

Surfaces in contact with food should be cleaned regularly to avoid cross contamination from different types of food, the use of hot clean water with a mild detergent is advisable when dealing with surfaces that come into contact with food. Correct food hygiene practises should always be followed at all times to avoid possibility of food poisoning /cross contamination.

Warning:

Do not immerse the motor base , power plug and cord in water or any other liquid to prevent the risk of electric shock.

Do not use rough scouring pads or cleansers on parts or finish.

Blades are very sharp. Handle with care.

Specifications

Supply Voltage..... 220~240V~ 50Hz
Power Consumption..... 350W

NOTE: As a result of continual improvements, the design and specifications of the product within may differ slightly to the unit illustrated on the packaging.

G | S | M

Gerard Sourcing & Manufacturing

GSM International Ltd.

GSM International Ltd has a policy of continual improvement throughout the product range.
As such the unit contained within may differ slightly from the unit illustrated on the pack.

MADE IN CHINA for GSM International Ltd.
Mistral is a registered trademark of GSM International Ltd.

Cat. No. MB555
September 2020