



# Stick Vacuum



## Instruction Manual

Model: MVC306

# Important Safeguards

**When using electrical appliances, in order to reduce the risk of fire, electric shock and/or injury, these basic safety precautions should always be followed:**

## For Your Safety

***Read all instructions carefully, even if you are familiar with the appliance.***

- This appliance is not intended for use by persons (including children) with reduced physical, sensory and mental capabilities, or lack of experience and knowledge, unless they have been given supervision or instruction concerning use of the appliance by a person responsible for their safety.
- Children should be supervised to ensure that they do not play with the appliance.
- This appliance is for household use only. Do not use this appliance for anything other than its intended use. Do not use in moving vehicles or boats. Do not use outdoors. Misuse may cause injury.
- Do not allow this appliance to be used as a toy. Close attention is necessary when used nearby children.
- Use only as described in this manual and only use manufacturer's recommended attachments.
- Do not use with damaged cord or plug.
- Do not handle charger or appliance with wet hands.
- Do not put any object into openings. Do not use with any opening blocked. Keep free of dust, lint, hair and anything that may reduce airflow.
- Keep hair, loose clothing, fingers and all parts of body away from openings and moving parts.
- Do not vacuum the following objects: toxic substances, flammable and explosive dangerous material, corrosive material and burning ash, matches, cigarette and combustible liquids, such as gasoline.
- Do not use the appliance to vacuum any dust harmful to health.
- Do not use without container and filter in place. Clean container and filter after picking up any perishable food items.
- Use only Handheld Vacuum Cleaner accessory, filter and charger.
- Do not vacuum water, liquids or other sharp objects like nails or drawing pins as they may damage the appliance.
- Do not pick up any objects which are smoking or burning, such as matches, cigarettes or hot ashes.
- Do not unplug the charger by pulling on the cord.
- Never carry the charger by the cord or to disconnect from an outlet; instead, grasp the charger and pull to disconnect. Do not pull cord around sharp edges or corners.
- Do not immerse the appliance, charger and cord in water or any other liquid.
- Always switch the appliance off when charging.
- Do not attempt to use the charger with any other product.
- The use of an extension cord is not recommended. Only plug the charger into a standard electrical outlet (230V or 240V outlet).
- Do not operate with a damaged charger and cord, or after the appliance has malfunctioned or been damaged in any manner.



# Warning

**Use only the charger supplied with this appliance to recharge this appliance.**

If the power cord is damaged, the power cord must be replaced by the manufacturer, its service agent or similarly qualified persons in order to avoid a hazard.

The Product uses a Lithium-ion Battery. Take care when removing an old Battery from the Main Body of the Stick Vacuum.

Ensure that old, used Batteries are disposed of in the correct manner. These should not be put in the domestic waste. Contact your local authority for indication of a suitable method of disposal or to locate your nearest collection point.

This product has not been designed for any uses other than those specified in this booklet.

## Save These Instructions

# Features of Your Stick Vacuum



## Part list

Main unit	Battery pack	Extension tube	Motorized brush head	2-in-1 upholstery nozzle
1	1	1	1	1
Charger	Carpet brush roller	Hard floor brush roller	Wall mount charger	
1	1	1	1	

## Main unit

1. Battery
2. Charging Socket
3. Battery Locker
4. ON/OFF Button
5. Speed Control Button
6. Power Indicator Light
7. Dust Cup Release Button
8. Dust Cup
9. Filter Cover Button
10. Filter Cover

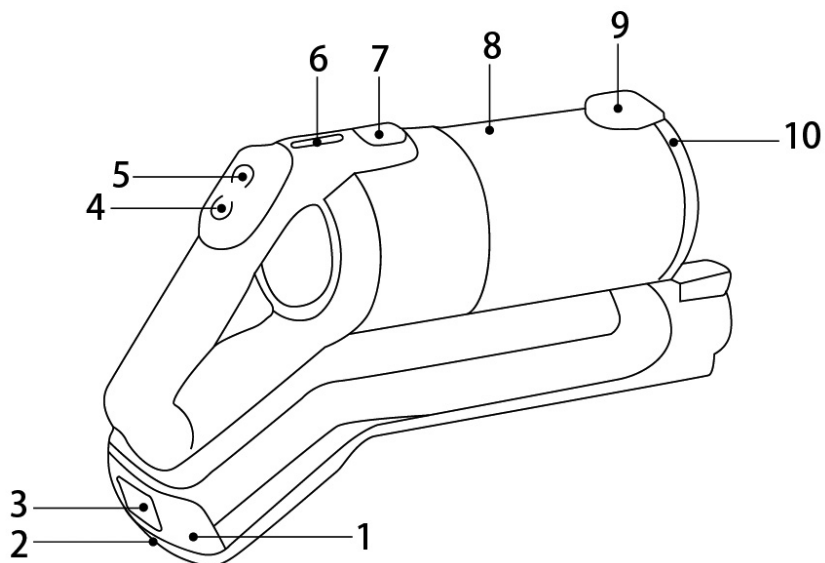

# Accessories

## Motorized brush



There are two brush rollers



Roller for hard floor



Roller for carpet floor

### How to replace the rollers:

1. There is a locking tab on the brush head, push it to Unlock position, the cover will pop out.

Locking tab Cover



Push the locking tab leftward to unlock



The cover pops up



Remove the cover



Remove the roller

2. Angle the geared end of the roller into brush holder cavity and align with gear of the brush holder, push the opposite end of the roller downwards into the locker cavity, place the cover back and push downwards until it clicks in position to lock it.



Geared end of roller



Gear on the brush head



Align the gear on the brush to the gear on the roller head



Other end of roller



Slide it into the slot on the roller holder



Place the cover back, push it downward to lock

## Getting to Know Your Stick Vacuum

Congratulations on the purchase of your new Stick Vacuum.

Before using this product for the first time. It is extremely important that you read and follow the instructions in this use and care booklet, even if you feel you are familiar with this type of appliance.

Your attention is drawn particularly to the section dealing with IMPORTANT SAFEGUARDS. Find a safe and convenient place to keep this booklet handy for future reference.

This appliance has been designed to operate from a standard domestic power outlet. It is not intended for industrial or commercial use.

## Before First Use

1. Carefully unpack appliance and remove all packaging materials.
2. Please retain all packaging until you have checked and count all the parts and the content against the parts list.
3. Charge the battery for 5 hours until fully charged.

## How to Assemble

### Assemble the battery pack

Align the slots of the battery pack to its holder on the Vacuum motor head, slide it forward, push it firmly until your hear it click to indicate it is locked into position.

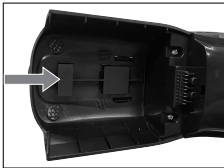

Holder for battery pack



Slots of battery pack

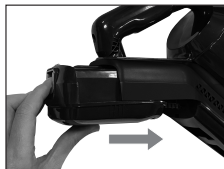

Slide-in the battery pack



Push the battery pack to lock in position

To remove the battery pack, slide locking tab downwards and slide/pull battery out to remove it.

Locking Tab



Push battery locking tab into the direction (as shown in photo above) to unlock and slide battery out to remove

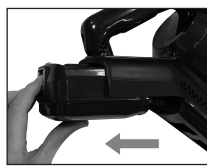

Slide battery pack out to remove

### How to assemble each part together

There is a rib on one part, a slot on another part, align the rib to the slot, insert them together firmly until you hear click and is secured in position.

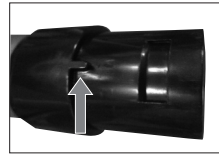

Rib on one part

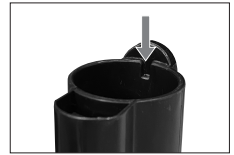

Slot on other part

### How to separate each part

The female (Slotted) connectors have a lock release button.

Press this button down whilst holding the part and pull with other hand on the mating part to separate.



Release button on one part

### Assemble handheld vacuum with extension tube and motorized brush

Can be used to clean carpets and hard floors.  
Tips: Please always turn off hand vacuum before attaching to parts.

#### 1. How to assemble extension tube to the vacuum motor head

Align the rib of the connector on the extension tube with the slot of the connector on vacuum motor head, push in until you hear it click in position and it is secured.

#### 2. How to assemble the motorized brush to the extension tube

Insert connector on the extension tube to the connector on the motorized brush, by aligning rib with slot, push in until your hear click and brush head is secured.

To remove brush head, press the release button on the connector of the extension tube to unlock, with other hand, pull brush head to remove.

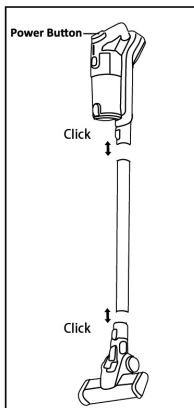

### 3. How to assemble vacuum motor head directly to the motorized brush head

This combination without the extension tube allows you get easier access to surfaces where use with extension tube is impractical, staircases, chairs etc.

Remove the extension tube from both vacuum motor head and the motorized brush head, by pressing the release buttons of the connectors and pulling extension tube out. You can now connect brush head directly to the vacuum motor head until it clicks into position to secure.



### Assemble vacuum motor head with 2-in-1 upholstery nozzle

1. The 2-in-1 upholstery nozzle accessory can be used with or without the extension tube to get into more difficult to reach places and connects/disconnects to extension tube or vacuum motor head direct in the same way as the motorized brush.

2. The 2 in 1 nozzle itself can be adapted as a brush style or micro vacuum head to suit your needs. Simply press the release buttons with thumb and fore finger to unlock and slide the brush section forward over the micro vacuum head and lock in position. To reverse simply press release buttons and slide it back.

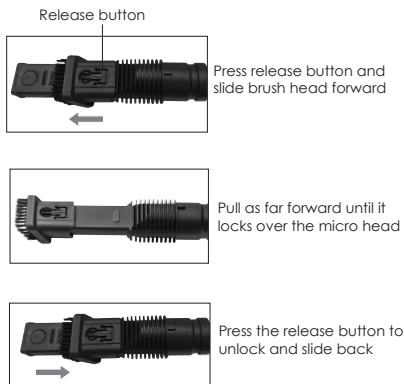

## How to use

After you are familiar with the assembly of this appliance and the use of the various accessories and their functions, you can now put this appliance to use.

With the battery pack fully charged and the desired accessory selected and attached, press the ON/OFF Button on the vacuum motor head to start the appliance. The power indicator light illuminates.

Press the Speed Control Button to select either Low or High speed. At Low speed the operating time is approximately 45 Minutes, at High speed 20 minutes.

When power indicator light starts flashing, switch the appliance OFF, it is time to recharge the battery.

**Warning: Never use this appliance to vacuum up liquids or water, it may damage this machine.**

# How to Charge

Tips: Please charge the product around 5 hours until fully charged before first use.

- Before charging, ensure to only use the charging adapter that was supplied with the vacuum cleaner.
- Position the vacuum head onto the wall mount charger.

When it is charging, the LED charge indicator light continuously flashes until it is fully charged, it then illuminates without flashing.

- When using the vacuum cleaner and battery is nearly drained, the vacuum LED indicator light will start flashing, prompting the user to place the vacuum back into the wall mount charging cradle to recharge.



Align the vacuum head with the contact point in the wall mounted charging cradle.

Push the vacuum head inwards to secure to the charging cradle.

- The battery pack can also be removed from the vacuum head and be charged with just the charging adapter directly, away from the charging cradle, this will require the charging adapter to be separated from the charging cradle.

When charging in this manner the LED indicator light illuminates Red and changes to Green when fully charged.

How to separate the charging adapter from the wall mount cradle.

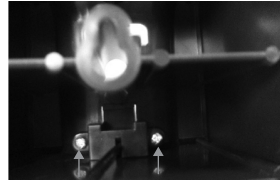

Remove the two screws

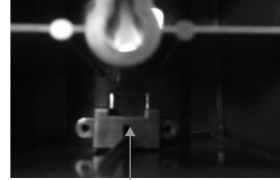

Remove this cover

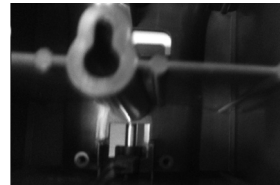

Take out the charging plug to remove it.

Place the adapter into a standard domestic power outlet, insert the charging plug into the battery pack's charging socket, the indicator light will keep flashing red during charging.

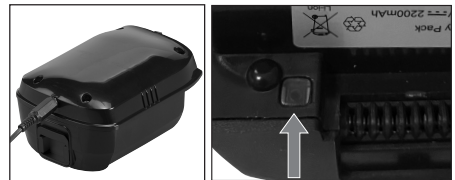

Indicator light

After fully charged, the indicator light will illuminate green. Remove the charging plug from the battery pack, and unplug the adapter from the power outlet.

# Care and Maintenance

## Main Unit, Floor Brush or Turbo Brush Head

Use a damp cloth to wipe of any dirt deposits from the external brush head enclosure if need arises.

Do not use abrasive cleaning agents (scouring agents, diluting agents) because they can damage the synthetic surface of the device.

**Warning: Don't let water enter into the motorized brush head as there are electrical terminations contained within and may irreparably damage.**

## Clean dust cup and filter

In order to achieve the best performance, empty the dust cup and clean filter screen after each use.

1. Turn off the vacuum cleaner.
2. Hold dust cup release button and take the dust cup out from vacuum cleaner.
3. Push lever to release bottom lid and debris will empty.
4. Take out the stainless steel filter screen and clean it with water.
5. Take white fabric filter and black foam filter out and clean them with water monthly.
6. Reassemble once completely dry.

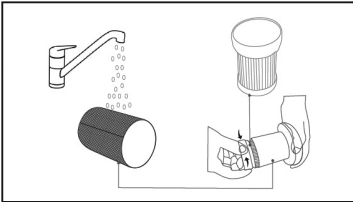
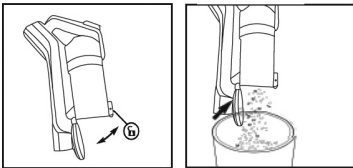

## Clean brush roller

1. Place motorized brush head upside down.
2. Push the Lock button to unlock position to take out the brush roller.
3. Use fingers and stiff brush to remove hair or debris.
4. Clean brush roller separately with water if needed.

Warning: Depending on use, over time the roller may have excessive hair or debris attached that need to be removed more regularly in order for the appliance to work efficiently, so check regularly and clean.

## Specification

Rating Voltage: 22.2V  
Working time 20-45mins  
Noise <=75db  
Suction 10Kpa  
Battery Adapter: input 100-240V 50/60Hz 0.5A  
Battery Adapter: output DC 26.5V 0.5A  
Battery type: Lithium battery  
Battery capacity 22.2V 2200mAh  
Charging time: Approx. 5 Hours

**Note: As a result of continual improvements, the design and specifications of the product within may differ slightly to the unit illustrated from the packaging.**



# Disposal

If the device is to be disposed of, it is best to remove the battery. Used batteries should not be disposed of with household waste; it should always be taken to the recycling center of the local authority. If you are unable to disassemble the product yourself, the local authorities recycling center will dispose of the product for you in an environmentally sound manner. In the event of product failure or damage, all inspections and repairs must be performed by a qualified electrician or technician.

# Troubleshooting

<b>Problem</b>	<b>Solution</b>
Vacuum will not work	<ol style="list-style-type: none"><li>1. The vacuum may have run out of battery power, make sure it is fully charged.</li><li>2. Push charger securely into electrical outlet, try another outlet or check circuit breaker.</li></ol>
Vacuum will not pick up dust or suction power is weak	<ol style="list-style-type: none"><li>1. Empty dust cup and clean or change filters.</li><li>2. Make sure cleaner is fully powered, charge battery.</li><li>3. Remove clogs that restrict the airflow.</li></ol>
The power button does not work while charging	It is normal when the vacuum is in charging mode, the power button will be locked for power off protection.

**G | S | M**

Gerard Sourcing & Manufacturing

**GSM International Ltd.**

GSM International Ltd has a policy of continual improvement throughout the product range.  
As such the unit contained within may differ slightly from the unit illustrated on the pack.

MADE IN CHINA for GSM International Ltd.  
Mistral is a registered trademark of GSM International Ltd.

Cat. No. MVC306  
October 2020